

oneup wall graphics

INSTALLATION INSTRUCTIONS

1. Prepare your surface. Find a suitable location for the graphic(s) – a wall with little to no texture will look best. Decals may not adhere as tightly to matte finish as to satin or semi-gloss finish, and are sensitive to extreme temperatures and sunlight. Before installation, clean wall with a damp cloth and dry off completely. If applying decal to a window or tile, make sure that the surface is clean and dry (avoid using chemical cleaners that may react with the water-based vinyl adhesive).

2. Prepare the graphic. To ensure that the graphics stick to the clear application tape, use the provided application tool and smooth over the back side of the graphic with moderate pressure.

3. Design your custom wall graphic. Some graphics come in multiples to a sheet, so you may need to cut them apart. Temporarily place decals on the wall with low tack masking tape – this way you can align or overlap graphics until you get the arrangement just right (fig 1). While the graphics are easily removable, they cannot be repositioned once stuck, so plan your design wisely!

4. Install your wall graphics. Apply low tack masking tape across one side of the decal, making a 'hinge' with the wall (fig 2). Lift up graphic and starting from one corner, slowly peel off backing paper, leaving decal stuck to the clear application tape (fig 3 & 4). If part of the decal should stick to the backing paper, rub the backing paper in the problem area and continue peeling. Careful – the back surface is now sticky!

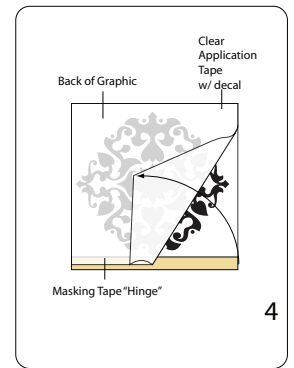
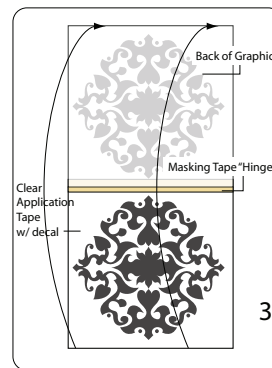
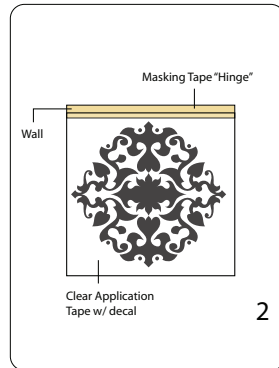
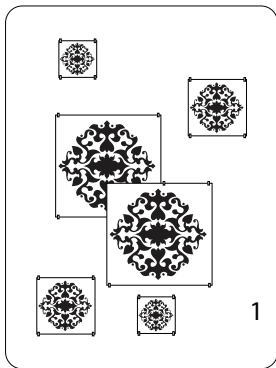

Bring decal down, pulling slightly from wall to keep it taut (fig 5). Working from the 'hinge', use the provided application tool to smooth over the entire decal with firm pressure, applying the graphic to your wall. Make sure to smooth over the whole surface with even pressure (fig 6).

Remove clear application tape by starting from a corner and slowly peeling back tape at a 180° angle, making sure that the decal is stuck to your wall as you pull (fig 7). If the part of the decal should stick to the clear application tape instead of the wall, don't panic! Stop peeling, lay decal back on the wall, smooth over problem area, and continue peeling. Repeat for remaining decals and stand back to admire your handiwork! (fig 8)

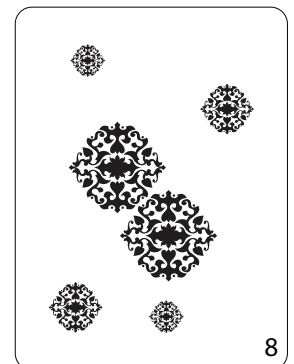
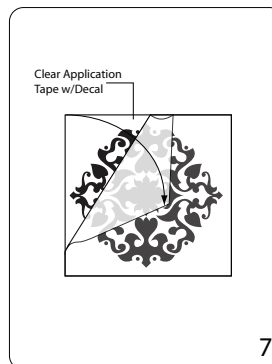
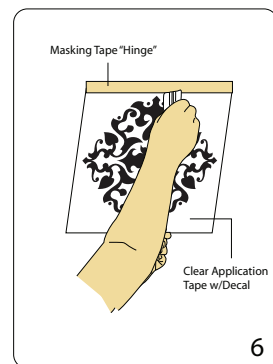
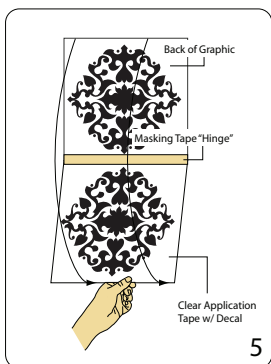

To remove One Up wall graphics, use a fingernail to gently pry up one corner of the decal and slowly pull off wall. One Up wall graphics have been successfully tested on a variety of surfaces including painted walls, sealed concrete floors, appliances, mirrors, windows, and tiles; however, One Up Designs cannot be held liable for hard-to-remove graphics or possible damage to surfaces.